

Forsiden

INNSATSER MF ORFS UNF INNSENDIG SVIVEL 90°

Anvendelse

Høytrykkslanger og lavtrykkslanger sammen med hylse med gripekant.

Brukere

Universelt.

Pakkflate

Plan.

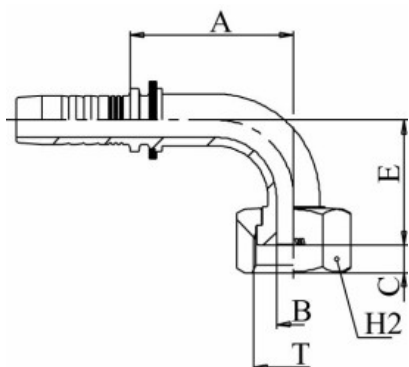

ORFS UNF Slange gjenge dim. tommetomme (T)	A mm	B mm	C mm	E mm	H2 mm	Materiale	Pakning	Varenr.	Hel pakning	Anbrekk	Sentrallager	An	
9/ 16-18	1/4	27,5	4,0	8,2	24,0	17	Stål	40	6554-04-04	81.00	116.00	P□ lager	1,0
9/16 - 18	3/8	28,0	4,0	8,0	23,0	19	Stål	15	6554-04-06	96.00	136.00	P□ lager	1,0
11/ 16-16	1/4	27,5	7,0	9,5	22,0	22	Stål	40	6554-06-04	87.00	124.00	P□ lager	1,0
11/ 16-16	5/16	32	7,0	9,5	23,0	22	Stål	40	6554-06-05	115.00	163.00	P□ lager	1,0
11/ 16-16	3/8	30,0	7,0	9,5	24,0	22	Stål	45	6554-06-06	99.00	142.00	P□ lager	1,0
11/ 16-16	1/2	30,9	7,0	9,5	24,5	22	Stål	30	6554-06-08	176.00	251.00	P□ lager	1,0
13/ 16-16	3/8	30,0	9,3	11,0	26,5	24	Stål	20	6554-08-06	130.00	185.00	P□ lager	1,0
13/ 16-16	1/2	40,5	9,3	11,0	30,0	24	Stål	30	6554-08-08	153.00	219.00	P□ lager	1,0

ORFS UNF gjenge tomme (T)	Slange dim. tomme	A mm	B mm	C mm	E mm	H2 mm	Materiale	Pakning	Varenr.	Hel pakning	Anbrekk	Sentrallager	An
16-16													
13/16 - 16	5/8	41,5	9,3	11,0	34,0	24	Stål	15	6554-08-10	325.00	465.00	Ikke p	lager 1,0
1-14	1/2	40,5	11,5	13,5	30,0	30	Stål	15	6554-10-08	257.00	370.00	P	lager 1,0
1-14	5/8	48,0	11,5	13,5	37,5	30	Stål	15	6554-10-10	271.00	390.00	P	lager 1,0
1-14	3/4	49,0	11,5	13,5	38,0	30	Stål	15	6554-10-12	370.00	530.00	P	lager 1,0
1 3/ 16-12	1/2	39,5	13,9	14,5	37,5	36	Stål	15	6554-12-08	370.00	530.00	P	lager 1,0
1-3/16	5/8	48,0	13,9	14,5	41,0	36	Stål	15	6554-12-10	385.00	545.00	P	lager 1,0
1 3/ 16-12	3/4	56,5	13,9	14,5	48,0	36	Stål	15	6554-12-12	330.00	465.00	P	lager 1,0
1 3/ 16-12	1	57,6	13,9	14,5	48,0	36	Stål	6	6554-12-16	540.00	770.00	P	lager 1,0
1-7/ 16-12	3/4	56,5	19,8	14,8	47,5	41	Stål	5	6554-16-12	540.00	770.00	P	lager 1,0
1 7/ 16-12	1	71,5	19,8	14,8	56,0	41	Stål	8	6554-16-16	575.00	820.00	P	lager 1,0
1 11/ 16-12	1	71,5	26,0	14,8	58,5	50	Stål	6	6554-20-16	880.00	1260.00	P	lager 1,0
1 11/ 16-12	1 1/4	83,0	26,0	14,8	66,0	50	Stål	6	6554-20-20	910.00	1300.00	P	lager 1,0
2-12	1 1/2	102,0	32,0	14,8	79,5	60	Stål	3	6554-24-24	1220.00	1730.00	P	lager 1,0