

Forsiden

# INNSATSER MF RØRSTUSS METRISK

## Anvendelse

Høytrykkslanger og lavtrykkslanger sammen med hylse med gripekant.

## Brukere

Universelt.

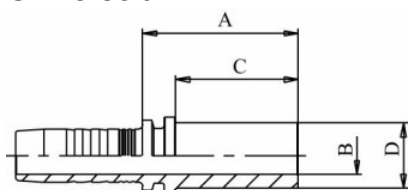

O.D rør mm (D)	Slange dim. tomme	A mm	B mm	C mm	D mm	Materiale	Pakning	Varenr.	Hel pakning	Anbrekk	Sentrallager	Antall
6	3/16	28,6	3,0	22,0	6,00	Stål	50	6572-06-03	30.00	43.00	P□ lager	1,00
6	1/4	29,5	3,0	22,0	6,00	Stål	100	6572-06-04	31.50	45.50	P□ lager	1,00
8	1/4	31,5	4,0	24,0	8,00	Stål	125	6572-08-04	28.50	40.50	P□ lager	1,00
10	1/4	33,5	4,0	26,0	10,00	Stål	100	6572-10-04	32.00	46.50	P□ lager	1,00
12	1/4	33,5	7,0	26,0	12,00	Stål	75	6572-12-04	54.00	77.00	P□ lager	1,00
10	5/16	30,5	7,0	23,0	10,00	Stål	75	6572-10-05	33.00	47.50	P□ lager	1,00
12	5/16	33,5	7,0	26,0	12,00	Stål	100	6572-12-05	40.50	58.00	P□ lager	1,00
10	3/8	30,6	7,0	23,0	10,00	Stål	50	6572-10-06	34.50	49.00	P□ lager	1,00
12	3/8	30,6	8,0	23,0	12,00	Stål	50	6572-12-06	31.00	44.50	P□ lager	1,00
13	3/8	35,6	7,0	28,0	13,25	Stål	100	6572-13-06	165.00	236.00	P□ lager	1,00
14	3/8	36,6	8,0	29,0	14,00	Stål	40	6572-14-06	59.00	84.00	P□ lager	1,00
15	3/8	32,6	10,5	25,0	15,00	Stål	40	6572-15-06	54.00	77.00	P□ lager	1,00
12	1/2	30,9	8,0	23,0	12,00	Stål	50	6572-12-08	78.00	110.00	P□ lager	1,00
14	1/2	36,9	9,3	29,0	14,00	Stål	40	6572-14-08	74.00	104.00	P□ lager	1,00
15	1/2	32,9	10,5	25,0	15,00	Stål	35	6572-15-08	54.00	77.00	P□ lager	1,00
16	1/2	37,9	10,5	30,0	16,00	Stål	45	6572-16-08	56.00	80.00	P□ lager	1,00
18	1/2	33,9	12,5	26,0	18,00	Stål	25	6572-18-08	92.00	130.00	P□ lager	1,00
18	5/8	34,2	12,5	26,0	18,00	Stål	30	6572-18-10	77.00	109.00	P□ lager	1,00
20	5/8	44,2	12,5	36,0	20,00	Stål	25	6572-20-10	95.00	136.00	P□ lager	1,00
18	3/4	36,2	15,0	26,0	18,00	Stål	15	6572-18-12	144.00	205.00	P□ lager	1,00

O.D rør mm (D)	Slange dim. tomme	A mm	B mm	C mm	D mm	Materiale	Pakning	Varenr.	Hel pakning	Anbrekk	Sentrallager	Antall
20	3/4	46,0	15,0	36,0	18,00	Stål	20	6572-20-12	164.00	234.00	P□ lager	1,00
22	3/4	38,0	15,0	28,0	22,00	Stål	40	6572-22-12	92.00	130.00	P□ lager	1,00
25	3/4	50,0	15,0	40,0	25,00	Stål	15	6572-25-12	171.00	243.00	P□ lager	1,00
25	1	51,3	15,0	40,0	25,00	Stål	20	6572-25-16	174.00	249.00	P□ lager	1,00
28	1	41,3	20,5	30,0	28,00	Stål	15	6572-28-16	209.00	299.00	P□ lager	1,00
30	1	55,3	20,5	44,0	30,00	Stål	15	6572-30-16	188.00	269.00	P□ lager	1,00
35	1 1/4	48,5	26,0	36,0	35,00	Stål	5	6572-35-20	320.00	465.00	P□ lager	1,00
38	1 1/4	62,5	26,0	50,0	38,00	Stål	8	6572-38-20	555.00	795.00	P□ lager	1,00
38	1 1/2	62,5	26,0	50,0	38,00	Stål	3	6572-38-24	660.00	940.00	P□ lager	1,00
42	1 1/2	52,6	32,0	40,0	42,00	Stål	3	6572-42-24	550.00	795.00	P□ lager	1,00

O.D rør mm (D)	Slange dim. tomme	A mm	B mm	C mm	D mm	Materiale	Varenr.	Pris pr. stk	Sentrallager	Antall
6	3/16	28,6	3,0	22,0	6,0	AISI 316	66572-06-03	På forespørsel	Ikke p□ lager	
6	1/4	29,5	3,0	22,0	6,0	AISI 316	66572-06-04	214.00	P□ lager	1,00
8	1/4	31,5	4,0	24,0	8,0	AISI 316	66572-08-04	213.00	P□ lager	1,00
10	1/4	33,5	4,0	26,0	10,0	AISI 316	66572-10-04	225.00	P□ lager	1,00
12	1/4	33,5	7,0	26,0	12,0	AISI 316	66572-12-04	236.00	P□ lager	1,00
12	5/16	33,5	7,0	26,0	12,0	AISI 316	66572-12-05	På forespørsel	Ikke p□ lager	
10	3/8	30,6	7,0	23,0	10,0	AISI 316	66572-10-06	261.00	P□ lager	1,00
12	3/8	30,6	8,0	23,0	12,0	AISI 316	66572-12-06	211.00	P□ lager	1,00
14	3/8	36,6	8,0	29,0	14,0	AISI 316	66572-14-06	430.00	P□ lager	1,00
15	3/8	32,6	10,5	25,0	15,0	AISI 316	66572-15-06	305.00	P□ lager	1,00
12	1/2	30,9	8,0	23,0	12,0	AISI 316	66572-12-08	400.00	P□ lager	1,00
14	1/2	36,9	9,3	29,0	14,0	AISI 316	66572-14-08	På forespørsel	Ikke p□ lager	
15	1/2	32,9	10,5	25,0	15,0	AISI 316	66572-15-08	350.00	P□ lager	1,00
16	1/2	37,9	10,5	30,0	16,0	AISI 316	66572-16-08	435.00	P□ lager	1,00
18	1/2	33,9	12,5	26,0	18,0	AISI 316	66572-18-08	390.00	P□ lager	1,00
16	5/8	39,0	12,5	31,6	16,0	AISI 316	66572-16-10	580.00	P□ lager	1,00
18	5/8	34,2	12,5	26,0	18,0	AISI 316	66572-18-10	296.00	P□ lager	1,00
20	5/8	44,2	12,5	36,0	20,0	AISI 316	66572-20-10	340.00	P□ lager	1,00
20	3/4	46,0	15,0	36,0	20,0	AISI 316	66572-20-12	475.00	P□ lager	1,00
22	3/4	38,0	15,0	28,0	22,0	AISI 316	66572-22-12	390.00	P□ lager	1,00
25	3/4	50,0	15,0	40,0	25,0	AISI 316	66572-25-12	615.00	P□ lager	1,00
25	1	51,3	15,0	40,0	25,0	AISI 316	66572-25-16	570.00	P□ lager	1,00
28	1	41,3	20,5	30,0	28,0	AISI 316	66572-28-16	730.00	P□ lager	1,00
30	1	55,3	20,5	44,0	30,0	AISI 316	66572-30-16	545.00	P□ lager	1,00
35	1 1/4	48,5	26,0	36,0	35,0	AISI 316	66572-35-20	660.00	P□ lager	1,00

O.D rør mm (D)	Slange dim. tomme	A mm	B mm	C mm	D mm	Materiale	Varenr.	Pris pr. stk	Sentrallager	Antall
38	1 1/4	62,5	26,0	50,0	38,0	AISI 316	66572-38-20	1280.00	På lager	1,00
38	1 1/2	62,5	26,0	50,0	38,0	AISI 316	66572-38-24	2200.00	På lager	1,00
42	1 1/2	52,6	32,0	40,0	42,0	AISI 316	66572-42-24	1500.00	Ikke på lager	1,00