

Forsiden

HYLSER MF

Anvendelse

Hydraulikkslanger i gummi.

Brukere

Universelt.

Merknader

Se pressetabell.

Pakningsstørrelse i AISI 316 = 1 stk.

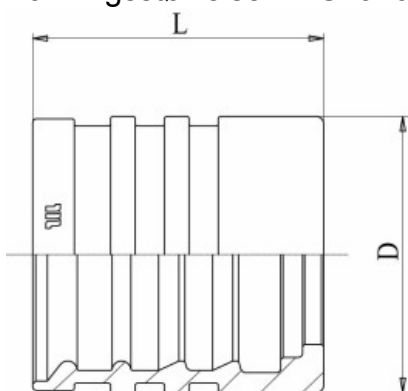

Dimensjon tomme	D mm	L mm	Materiale	Pakning	Varenr.	Hel pakning	Anbrekk	Sentrallager	Antall
For slange: 5166, 5350, 5450, 5520, 5521, 5528, 5529, 5530, 52500									
1/4	19,5	28,0	Stål	150	65113-04	19.00	27.50	P□ lager	1,00
5/16	20,0	28,6	Stål	100	65113-05	20.50	29.00	P□ lager	1,00
3/8	23,0	30,0	Stål	100	65113-06	23.00	32.50	P□ lager	1,00
1/2	26,7	32,0	Stål	50	65113-08	30.50	44.00	P□ lager	1,00
5/8	32,0	38,0	Stål	50	65113-10	47.50	69.00	P□ lager	1,00
3/4	35,8	41,7	Stål	40	65113-12	59.00	84.00	P□ lager	1,00
1	43,0	47,0	Stål	30	65113-16	90.00	129.00	P□ lager	1,00
For slange: 528, 529, 5166, 5162, 5282, 5250, 5256, 5262, 5428, 5451, 5450, 5528, 5625, 10518									
3/16	21,0	23,0	Stål	70	65125-03	21.50	31.00	P□ lager	1,00
1/4	23,0	30,1	Stål	150	65125-04	17.00	24.00	P□ lager	1,00
5/16	24,0	30,0	Stål	150	65125-05	22.00	31.50	P□ lager	1,00
3/8	26,0	31,1	Stål	150	65125-06	21.50	30.50	P□ lager	1,00
1/2	29,0	33,4	Stål	70	65125-08	27.50	39.50	P□ lager	1,00
5/8	33,0	37,0	Stål	50	65125-10	38.00	54.00	P□ lager	1,00
3/4	37,0	42,0	Stål	50	65125-12	47.50	68.00	P□ lager	1,00
1	46,0	51,0	Stål	15	65125-16	92.00	132.00	P□ lager	1,00

Dimensjon tomme	D mm	L mm	Materiale	Pakning	Varenr.	Hel pakning	Anbrekk	Sentrallager	Antall
1 1/4	59,0	57,2	Stål	15	65125-20	212.00	305.00	P□ lager	1,00
1 1/2	67,0	64,8	Stål	10	65125-24	315.00	455.00	P□ lager	1,00
2	80,0	68,3	Stål	8	65125-32	490.00	700.00	P□ lager	1,00
2 1/2	88,2	68,8	Stål	8	65125-40	755.00	1080.00	P□ lager	1,00
3	103,0	75,0	Stål	4	65125-48	935.00	1330.00	P□ lager	1,00
For slange: 529, 547, 5250, 5256, 5350, 5489, 5512, 5526, 5529, 5530, 5892, 10518, 52500, 55280, 55350 (3/8, 1/2, 3/4, 1")									
1/4	22,0	30,0	Stål	150	65124-04	21.50	30.50	P□ lager	1,00
5/16	24,0	31,0	Stål	100	65124-05	27.50	39.00	P□ lager	1,00
3/8	26,0	33,0	Stål	150	65124-06	25.00	35.50	P□ lager	1,00
1/2	30,0	34,0	Stål	100	65124-08	33.00	48.00	P□ lager	1,00
5/8	33,0	39,0	Stål	50	65124-10	44.00	63.00	P□ lager	1,00
3/4	38,0	40,0	Stål	50	65224-12	56.00	80.00	P□ lager	1,00
1	46,0	54,0	Stål	30	65224-16	107.00	153.00	P□ lager	1,00
1 1/2	65,0	70,0	Stål	10	65124-24	310.00	440.00	P□ lager	1,00
1 1/4	57,0	60,0	Stål	15	65224-20	186.00	265.00	P□ lager	1,00
2	79,0	72,0	Stål	8	65124-32	445.00	640.00	P□ lager	1,00
For slange: 535, 5451									
1/4	18,0	29,6	Stål	50	65236-04	14.50	21.00	P□ lager	1,00
5/16	19,0	31,9	Stål	20	65236-05	18.00	25.50	P□ lager	1,00

Dimensjon tomme	D mm	L mm	Materiale	Varenr.	Pris pr. stk	Sentrallager	Antall
For slange: 5166, 5350, 5450, 5520, 5521, 5528, 5529, 5530, 52500							
1/4	19,5	28,0	AISI 316	665113-04	245.00	P□ lager	1,00
5/16	20,0	28,6	AISI 316	665113-05	257.00	P□ lager	1,00
3/8	23,0	30,0	AISI 316	665113-06	257.00	P□ lager	1,00
1/2	26,7	32,0	AISI 316	665113-08	305.00	P□ lager	1,00
5/8	32,0	38,0	AISI 316	665113-10	455.00	P□ lager	1,00
3/4	35,8	41,0	AISI 316	665113-12	530.00	P□ lager	1,00
1	43,0	47,0	AISI 316	665113-16	805.00	P□ lager	1,00
For slange: 528, 529, 5166, 5162, 5250, 5256, 5262, 5282, 5428, 5451, 5450, 5528, 5625, 10518							
1/4	23,0	30,5	AISI 316	665125-04	207.00	P□ lager	1,00
5/16	24,0	30,0	AISI 316	665125-05	259.00	P□ lager	1,00
3/8	26,0	32,0	AISI 316	665125-06	214.00	P□ lager	1,00
1/2	29,0	34,0	AISI 316	665125-08	234.00	P□ lager	1,00
5/8	33,0	37,0	AISI 316	665125-10	305.00	P□ lager	1,00
3/4	37,0	42,0	AISI 316	665125-12	405.00	P□ lager	1,00
1	46,0	51,0	AISI 316	665125-16	585.00	Ikke p□ lager	1,00
1 1/4	59,0	59,0	AISI 316	665125-20	980.00	P□ lager	1,00
1 1/2	67,0	67,0	AISI 316	665125-24	1420.00	P□ lager	1,00

Dimensjon tomme	D mm	L mm	Materiale	Varenr.	Pris pr. stk	Sentrallager	Antall
2	80,0	72,0	AISI 316	665125-32	2000.00	P□ lager	1,00
For slange: 529, 547, 5250, 5256, 5350, 5489, 5512, 5528, 5526, 5529, 5530, 5892, 10518, 52500, 55350 (3/8, 1/2, 3/4, 1")							
1/4	22,0	30,0	AISI 316	665124-04	233.00	P□ lager	1,00
3/8	26,0	33,0	AISI 316	665124-06	232.00	P□ lager	1,00
1/2	30,0	34,0	AISI 316	665124-08	264.00	P□ lager	1,00
5/8	33,0	39,0	AISI 316	665124-10	425.00	Ikke p□ lager	1,00
1 1/2	65,0	70,0	AISI 316	665124-24	1630.00	Ikke p□ lager	1,00
2	79,0	72,0	AISI 316	665124-32	2690.00	P□ lager	1,00
3/4	38,0	40,0	AISI 316	665224-12	470.00	P□ lager	1,00
1	46,0	54,0	AISI 316	665224-16	710.00	P□ lager	1,00
1 1/4	57,0	60,0	AISI 316	665224-20	1060.00	P□ lager	1,00